

- 1.0 PERFORMANCE
 1.1 FREQUENCY RANGE: DC-18 GHz
 1.2 VOLTAGE RATING: 500V RMS (sea level)
 1.3 NOMINAL IMPEDANCE: 50 OHMS
 1.4 DWV: 1500 V RMS @ 60 Hz (sea level)
 1.5 TEMPERATURE RANGE: -65°C TO +165°C
 1.6 VSWR: (1.10, 7 GHz), (1.20, 12.4 GHz), (1.60, 18GHz)
 1.7 GROUP DELAY: 221.4 PSEC NOMINAL

- 2.0 MATERIALS
 2.1 DIELECTRIC: PTFE
 2.2 CONTACTS: BRASS
 2.3 RETAINING RING, TYPE N, PHOSPHOR BRONZE
 2.4 RETAINING RING, TYPE SMA, BeCu
 2.5 OTHER METAL PARTS: BRASS
 3.0 FINISHES: SEE TABLE
 4.0 MECHANICAL
 4.1 INTERFACES IN ACCORDANCE WITH MIL-STD-348

DWG NO. OL-0910-12-1			REV. C
PART NUMBER	BODY	CONTACT	C-NUT
0910-12-NG	Ni	GOLD/Cu	Ni
0910-12-SGA	SILVER	GOLD/Cu	ALBALOY

PLATE PER STI 7.3.1-8

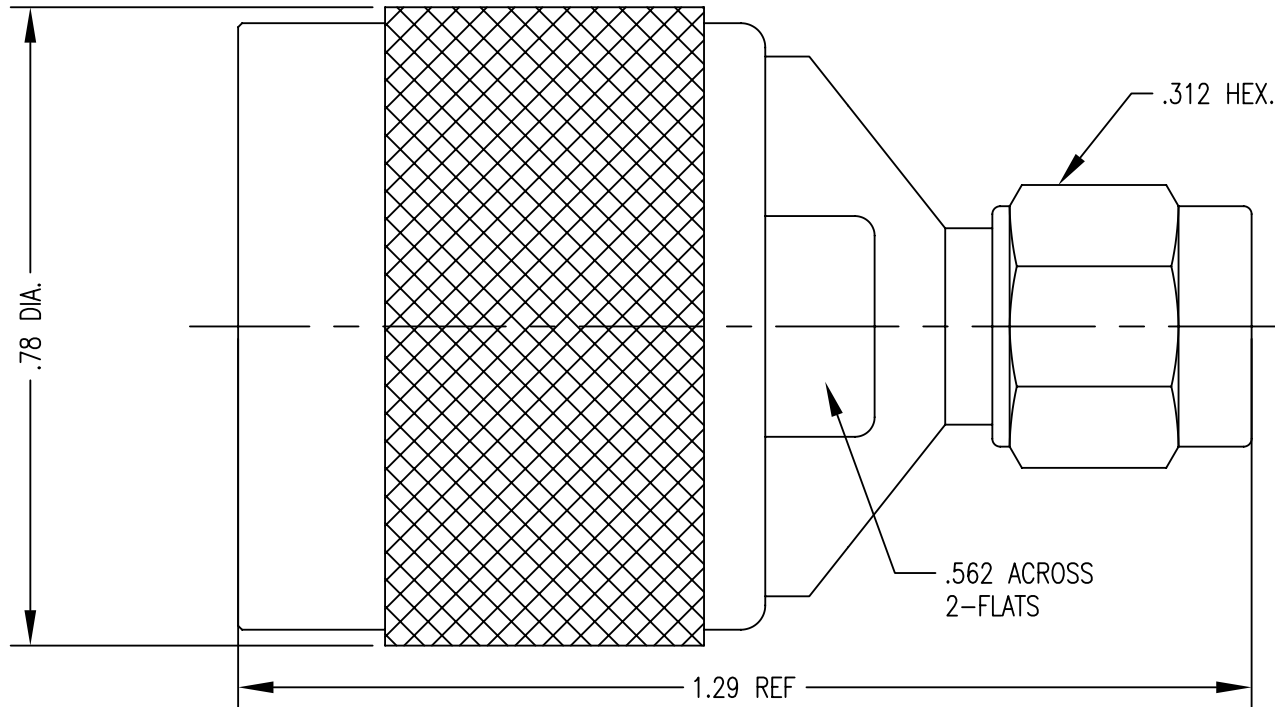

C	ADD NOTE 1.6 & 1.7	10/2/09	FSH	FSH
B	FREQ RANGE WAS 11 GHz / ADD PLATING TABLE / OAL WAS 1.25	10-20-08	FSH	FSH
A	ORIGINAL	8/15/97	<input checked="" type="checkbox"/>	<input checked="" type="checkbox"/>
Rev.	Revisions	Date	Dwn.	Appd.
RECOM. STOCK SIZE	FT/M PCS	QTY REQD		

PROPRIETARY
 THIS DRAWING CONTAINS CONFIDENTIAL INFORMATION PROPRIETARY TO SAN*TRON INC. IT MUST NOT BE REPRODUCED OR DISCLOSED TO OTHERS OR USED IN ANY OTHER WAY, IN WHOLE OR PART EXCEPT AS AUTHORIZED IN WRITING BY SAN*TRON INCORPORATED.

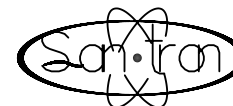

SAN • TRON, INC.

4 NEWBURYPORT TPK, IPSWICH, MA 01938

REMOVE ALL BURRS AND SHARP EDGES .005 MAX.
 UNLESS OTHERWISE STATED ALL DIMENSIONS ARE IN INCHES AND APPLY AFTER PLATING

UNSPECIFIED TOL.	DWN	KC	8/15/97
DEC. ± .005	CHKD	JTO	8/15/97
FRAC. ± 1/64	APPR	JTO	8/15/97
ANG. ± 1/2'			

CONCENTRICITY .004 TIR
 ALL MACHINED SUFACES

TITLE ADAPTER, STRAIGHT SMA (M)-N (M)	
MATERIAL: SEE 2.0	FINISH: SEE 3.0
FSCM NO. 50896	DWG NO. OL-0910-12-1
SCALE 4:1	REV. C