

Zener Diode Chip Series

CD5221B thru CD5272B



Features

- All junctions completely protected with silicon dioxide
- Electrically equivalent to IN5221B thru IN5272B
- 0.5 Watt capability with proper heat sinking
- Compatible with all wire bonding and die attach techniques with the exception of solder reflow

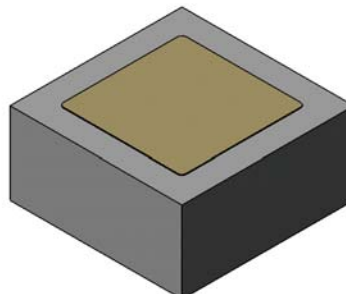

Maximum Ratings

Operating Temperature: -65°C to +175°C

Storage Temperature: -65°C to +175°C

Forward Voltage @ 200mA: 1.5 volts maximum

Electrical Specifications @ +25 °C (Unless Otherwise Specified)

TYPE NUMBER	NOMINAL ZENER VOLTAGE (NOTE 1 & 3)	ZENER TEST CURRENT	MAXIMUM ZENER IMPEDANCE (NOTE 2)		MAXIMUM REVERSE CURRENT	
	$V_Z @ I_{ZT}$	I_{ZT}	$Z_{ZT} @ I_{ZT}$	$Z_{ZK} @ I_{ZK} = 250 \mu A$	$I_R @ V_R$	
	VOLTS	mA	OHMS	OHMS	μA	VOLTS
CD5221B	2.4	20	30	1200	100	1.0
CD5222B	2.5	20	30	1250	100	1.0
CD5223B	2.7	20	30	1300	75	1.0
CD5224B	2.8	20	30	1400	75	1.0
CD5225B	3.0	20	29	1600	50	1.0
CD5226B	3.3	20	28	1600	25	1.0
CD5227B	3.6	20	24	1700	15	1.0
CD5228B	3.9	20	23	1900	10	1.0
CD5229B	4.3	20	22	2000	5.0	1.0
CD5230B	4.7	20	19	1900	5.0	2.0
CD5231B	5.1	20	17	600	5.0	2.0
CD5232B	5.6	20	11	1600	5.0	3.0
CD5233B	6.0	20	7.0	1600	5.0	3.5
CD5234B	6.2	20	7.0	1000	5.0	4.0
CD5235B	6.8	20	5.0	750	3.0	5.0
CD5236B	7.5	20	6.0	500	3.0	6.0
CD5237B	8.2	20	8.0	500	3.0	6.5
CD5238B	8.7	20	8.0	600	3.0	6.5
CD5239B	9.1	20	10	600	3.0	7.0
CD5240B	10	20	17	600	3.0	8.0
CD5241B	11	20	22	600	2.0	8.4
CD5242B	12	20	30	600	1.0	9.1
CD5243B	13	9.5	13	600	0.5	9.9
CD5244B	14	9.0	15	600	0.1	10
CD5245B	15	8.5	16	600	0.1	11
CD5246B	16	7.8	17	600	0.1	12
CD5247B	17	7.4	19	600	0.1	13
CD5248B	18	7.0	21	600	0.1	14
CD5249B	19	6.6	23	600	0.1	14
CD5250B	20	6.2	25	600	0.1	15

(continued next page)



Electrical Specifications @ +25 °C (Unless Otherwise Specified)

TYPE NUMBER	NOMINAL ZENER VOLTAGE (NOTE 1)	ZENER TEST CURRENT	MAXIMUM ZENER IMPEDANCE (NOTE 2)		MAXIMUM REVERSE CURRENT	
	$V_Z @ I_{ZT}$	I_{ZT}	$Z_{ZT} @ I_{ZT}$	$Z_{ZK} @ I_{ZK} = 250 \mu A$	$I_R @ V_R$	
	VOLTS	mA	OHMS	OHMS	μA	VOLTS
CD5251B	22	5.6	29	600	0.1	17
CD5252B	24	5.2	33	600	0.1	18
CD5253B	25	5.0	35	600	0.1	19
CD5254B	27	4.6	41	600	0.1	21
CD5255B	28	4.5	44	600	0.1	21
CD5256B	30	4.2	49	600	0.1	23
CD5257B	33	3.8	58	700	0.1	25
CD5258B	36	3.4	70	700	0.1	27
CD5259B	39	3.2	80	800	0.1	30
CD5260B	43	3.0	93	900	0.1	33
CD5261B	47	2.7	105	1000	0.1	36
CD5262B	51	2.5	125	1100	0.1	39
CD5263B	56	2.2	150	1300	0.1	43
CD5264B	60	2.1	170	1400	0.1	46
CD5265B	62	2.0	185	1400	0.1	47
CD5266B	68	1.8	230	1600	0.1	52
CD5267B	75	1.7	270	1700	0.1	56
CD5268B	82	1.5	330	2000	0.1	62
CD5269B	87	1.4	370	2200	0.1	68
CD5270B	91	1.4	400	2300	0.1	69
CD5271B	100	1.3	500	2600	0.1	76
CD5272B	110	1.1	750	3000	0.1	84

NOTE 1 Zener voltage range equals "nominal Zener voltage" (see table) $\pm 5\%$, for "B" Suffix types. "A" Suffix denotes $\pm 10\%$. No Suffix denotes $\pm 20\%$. "C" suffix = $\pm 2\%$ tolerance and "D" suffix = $\pm 1\%$ tolerance.

NOTE 2 Zener impedance is derived by superimposing on I_{ZT} 60 Hz rms ac current equal to 250 μA .

NOTE 3 Zener voltage is read using a pulse measurement, 10 milliseconds maximum.

Outline Drawing

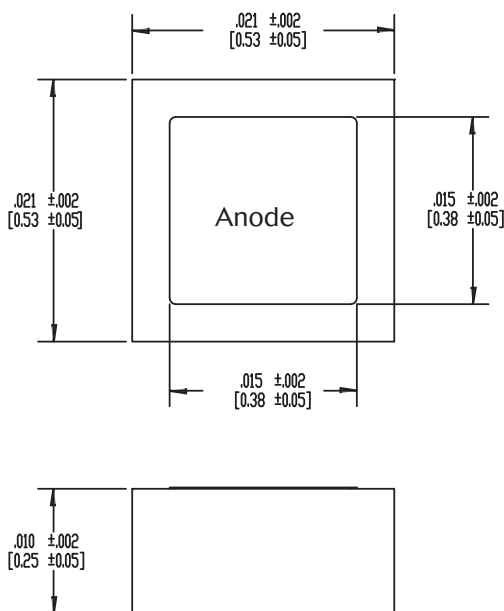

DESIGN DATA

METALLIZATION: Top: (Anode) Al
Back: (Cathode) Au

AL THICKNESS: 25,000 Å Minimum

GOLD THICKNESS: 4,000 Å Minimum

CHIP THICKNESS: 10 Mils

CIRCUIT LAYOUT DATA: For Zener operation, cathode must be operated positive with respect to anode.

Graphs

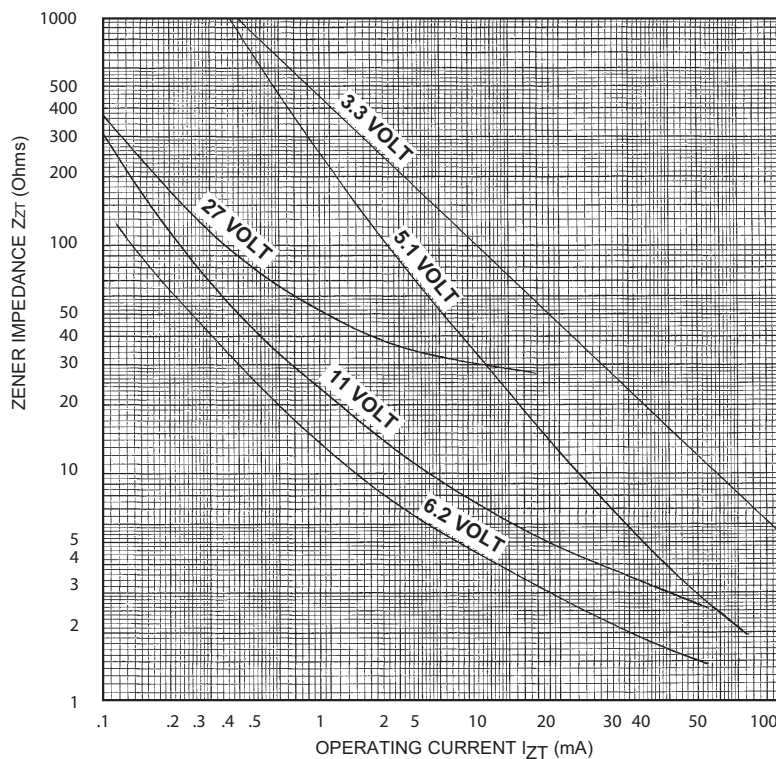
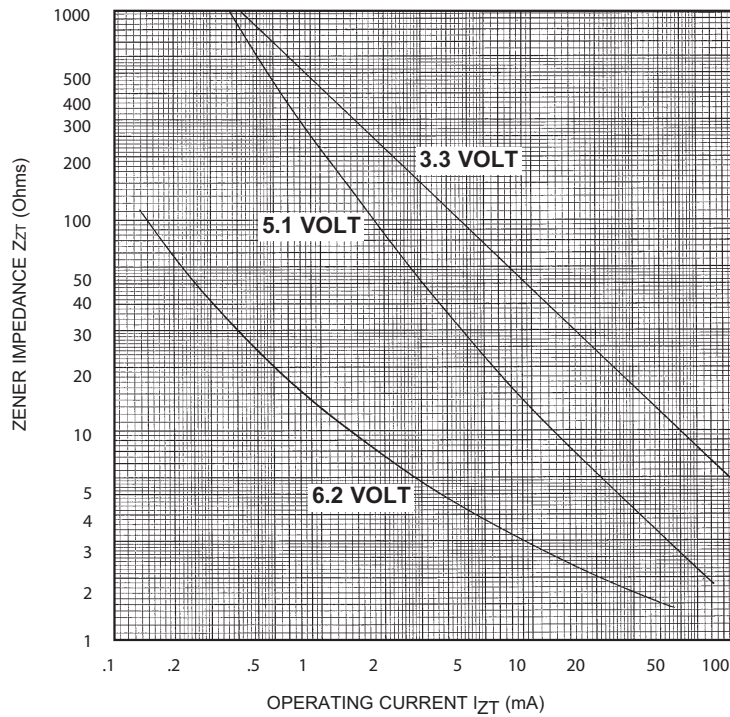

ZENER IMPEDANCE VS. OPERATING CURRENT

Aeroflex / Metelics, Inc.

975 Stewart Drive,
Sunnyvale, CA 94085

Tel: (408) 737-8181

Fax: (408) 733-7645

Sales: 888-641-SEMI (7364)

Hi-Rel Components

9 Hampshire Street,
Lawrence, MA 01840

Tel: (603) 641-3800

Fax: (978) 683-3264

www.aeroflex.com/metelics-hirelcomponents

www.aeroflex.com/metelics metelics-sales@aeroflex.com

Aeroflex / Metelics, Inc. reserves the right to make changes to any products and services herein at any time without notice. Consult Aeroflex or an authorized sales representative to verify that the information in this data sheet is current before using this product. Aeroflex does not assume any responsibility or liability arising out of the application or use of any product or service described herein, except as expressly agreed to in writing by Aeroflex; nor does the purchase, lease, or use of a product or service from Aeroflex convey a license under any patent rights, copyrights, trademark rights, or any other of the intellectual rights of Aeroflex or of third parties.

Copyright 2012 Aeroflex / Metelics. All rights reserved.

ISO 9001: 2008 certified companies



Our passion for performance is defined by three attributes represented by these three icons: solution-minded, performance-driven and customer-focused.