

REVISIONS				
ZONE	REV	DESCRIPTION	DATE	APPROVED

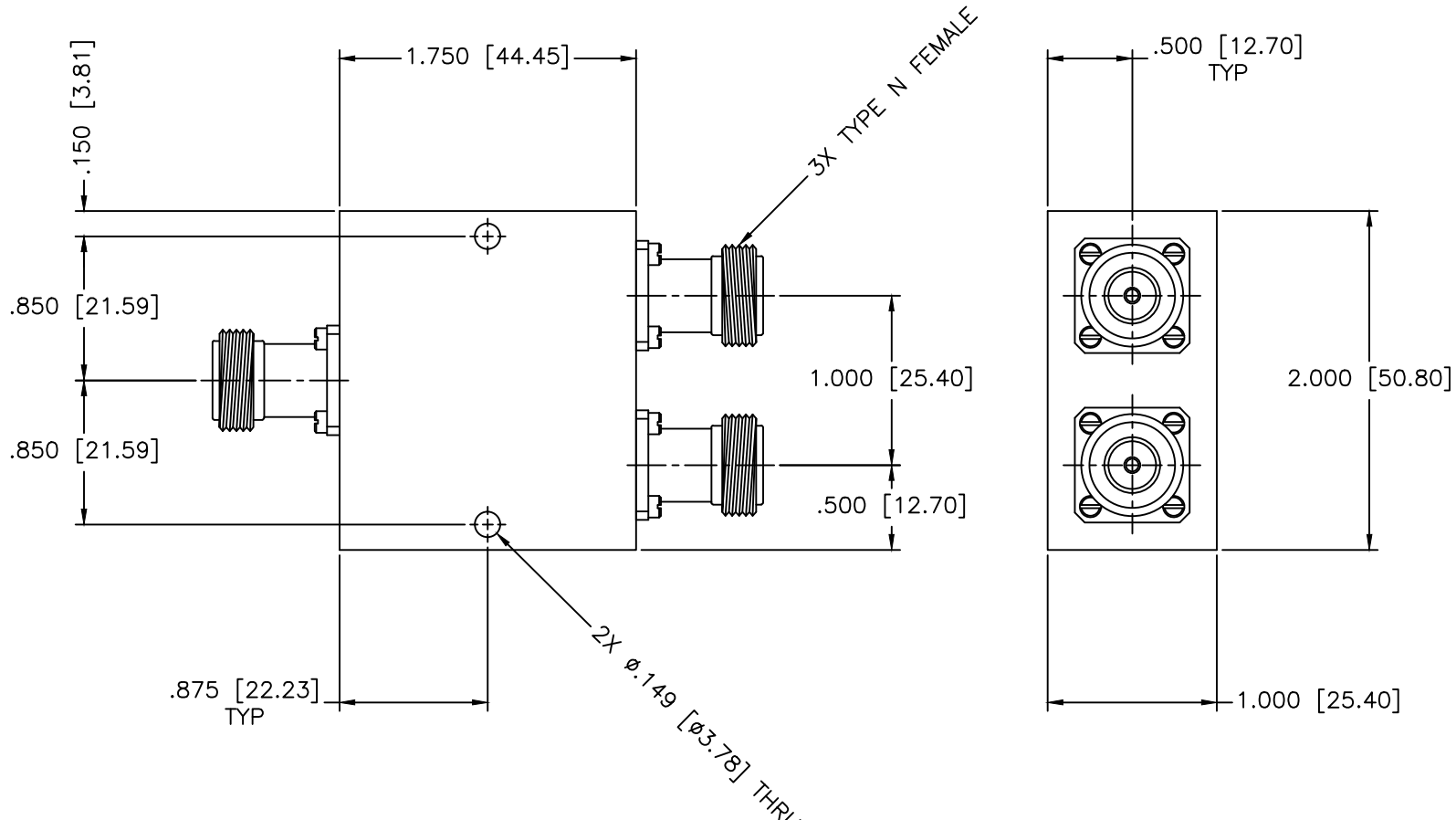

SPECIFICATIONS

Frequency Range: 0.85–3.5 GHz
 Insertion Loss: 0.4dB Max.
 Isolation: 20dB Min.
 VSWR In/Out: 1.35:1/1.30:1 Max.
 Phase Balance: ± 4 Deg. Max.
 Amplitude Balance: ± 0.2 dB Max.
 Power: 30 Watts (Load vswr@1.2)

MATERIAL:	
DRAWN: Paiboon Luekhamhan	DATE: 02-18-1998
APPROVED: T. Nguyen	DATE: 02-18-1998

	MICROWAVE COMMUNICATIONS LABORATORIES INC. 7255 30TH AVE. N. SAINT PETERSBURG, FL 33710 TEL: (727) 344-6254 FAX: (727) 381-6116 http://WWW.MCLI.COM		SCALE: N/A
	UNLESS OTHERWISE SPECIFIED: TOLERANCES IN (INCHES) OR [mm] (MILLIMETERS) FRACTIONS: $\pm 1/64$ DECIMALS: $\pm 0.01 \pm 0.005$ ANGLE: $\pm 1/2^\circ$		SHEET: N/A
DRAWING TITLE: 2-WAY POWER DIVIDER		PART NO. PS2-80/NF	
CAGE CODE: OD2L5	SIZE: A	REV: N/A	DWG NO. 80912
DO NOT SCALE THE DRAWING			

PROPRIETARY NOTICE:
 THE INFORMATION IN THIS DRAWING IS PROPRIETARY
 AND SHALL NOT BE USED OR DISCLOSED WITHOUT WRITTEN
 PERMISSION FROM MICROWAVE COMMUNICATIONS
 LABORATORIES INC. (MCLI)

